

## HANSA Filter drier sight glass combination steel HMK163 sm FI 2838410050



### Product short description:

Filter drier sight glass combination steel  
HMK163 sm FI  
60 bar  
Dimension (LxWxH): 198x75x75 mm  
Weight: 0,715 kg  
Part-No.: 2838410050

Made in Germany

### Product codes:

Reference: 2838410050  
EAN13: 4251692918746

### Product description:

HANSA filter drier combis a compact steel version with copper pipes as solder connections. Time-saving assembly and full insight during maintenance, as the familiar sight glass sizes are used. For the system supplier, here comes the ideal complement: combis with solder connection and large sight glass in a steel housing. The space-saving and lighter design of the combis allows the manufacturer to make his systems more compact. No compromises were made in the sight glass itself.

The diameter of the glass is the same as that of the other units, and it can be supplied with or without an indicator.

Made in Germany

### Product features:

### Product attributes:

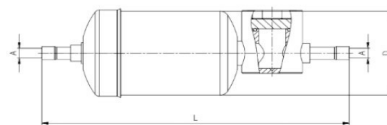

## HANSA Artikeliste Multiplex - Kombis Lötanschluss

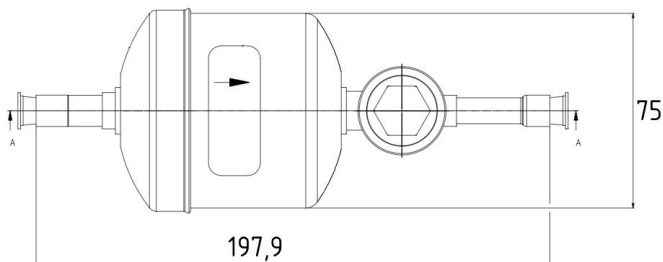

Beschreibung		Maße				Gewicht	P max.
Typ	HANSA Best. Nr.	für Rohr ø	A	D	L +/-3mm		
Multiplex Kombi Stahl HMK082 sm FI	2837406050	6	6,1	52	172,0	0,47	60
Multiplex Kombi Stahl HMK083 sm FI	2837410050	10	10,1	52	188,0	0,47	60
Multiplex Kombi Stahl HMK084 sm FI	2837412050	12	12,1	52	180,0	0,48	60
Multiplex Kombi Stahl HMK162 sm FI	2838406050	6	6,1	75	182,0	0,71	55
Multiplex Kombi Stahl HMK163 sm FI	2838410050	10	10,1	75	198,0	0,72	55
Multiplex Kombi Stahl HMK164 sm FI	2838412050	12	12,1	75	191,0	0,72	55
Multiplex Kombi Stahl HMK082 sm SG	2837506050	6	6,1	52	172,0	0,47	55
Multiplex Kombi Stahl HMK083 sm SG	2837510050	10	10,1	52	188,0	0,47	60
Multiplex Kombi Stahl HMK084 sm SG	2837512050	12	12,1	52	180,0	0,47	60
Multiplex Kombi Stahl HMK162 sm SG	2838506050	6	6,1	75	182,0	0,71	60
Multiplex Kombi Stahl HMK163 sm SG	2838510050	10	10,1	75	198,0	0,71	55
Multiplex Kombi Stahl HMK164 sm SG	2838512050	12	12,1	75	191,0	0,71	55

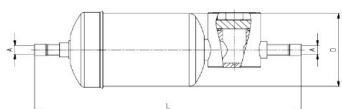

Beschreibung		Empfohlen bis Kälteleistung						Wasseraufnahmefähigkeit bei 25°C gemessen nach ARI-Standard 710-86				
Typ	HANSA Best. Nr.	R134a	R404A	R407C	R410A	R449A	R134a	R404A	R407C	R410A	R449A	
		R1234L	R507A			R452A	R1234L	R507A			R452A	
		KW	KW	KW	KW	KW	g	g	g	g	g	
Multiplex Kombi Stahl HMK082 sm FI	2837406050	13,00	9,00	14,50	14,50	9,00	12,2	13,9	12,2	12,0	12,1	
Multiplex Kombi Stahl HMK083 sm FI	2837410050	13,00	9,00	14,50	14,50	9,00	12,2	13,9	12,2	12,0	12,1	
Multiplex Kombi Stahl HMK084 sm FI	2837412050	13,00	9,00	14,50	14,50	9,00	12,2	13,9	12,2	12,0	12,1	
Multiplex Kombi Stahl HMK162 sm FI	2838406050	23,00	16,00	25,00	25,00	16,00	19,2	21,9	19,2	19,0	19,2	
Multiplex Kombi Stahl HMK163 sm FI	2838410050	23,00	16,00	25,00	25,00	16,00	19,2	21,9	19,2	19,0	19,2	
Multiplex Kombi Stahl HMK164 sm FI	2838412050	23,00	16,00	25,00	25,00	16,00	19,2	21,9	19,2	19,0	19,2	
Multiplex Kombi Stahl HMK082 sm SG	2837506050	13,00	9,00	14,50	14,50	9,00	12,2	13,9	12,2	12,0	12,1	
Multiplex Kombi Stahl HMK083 sm SG	2837510050	13,00	9,00	14,50	14,50	9,00	12,2	13,9	12,2	12,0	12,1	
Multiplex Kombi Stahl HMK084 sm SG	2837512050	13,00	9,00	14,50	14,50	9,00	12,2	13,9	12,2	12,0	12,1	
Multiplex Kombi Stahl HMK162 sm SG	2838506050	23,00	16,00	25,00	25,00	16,00	19,2	21,9	19,2	19,0	19,2	
Multiplex Kombi Stahl HMK163 sm SG	2838510050	23,00	16,00	25,00	25,00	16,00	19,2	21,9	19,2	19,0	19,2	
Multiplex Kombi Stahl HMK164 sm SG	2838512050	23,00	16,00	25,00	25,00	16,00	19,2	21,9	19,2	19,0	19,2	