

HANSA Filter drier sight glass combination steel HMK164 sm SG 2838512050

Product short description:

Filter drier sight glass combination steel
HMK164 sm SG
60 bar
Dimension (LxWxH): 191x75x75 mm
Weight: 0,714 kg
Part-No.: 2838512050

Made in Germany

Product codes:

Reference: 2838512050
EAN13: 4251692918814

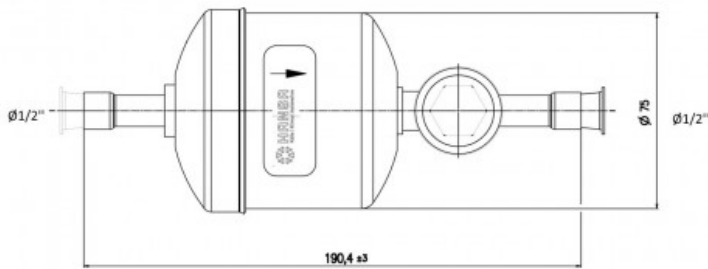

HANSA 2838512050

Product description:

HANSA filter drier combis a compact steel version with copper pipes as solder connections. Time-saving assembly and full insight during maintenance, as the familiar sight glass sizes are used. For the system supplier, here comes the ideal complement: combis with solder connection and large sight glass in a steel housing. The space-saving and lighter design of the combis allows the manufacturer to make his systems more compact. No compromises were made in the sight glass itself. The diameter of the glass is the same as that of the other units, and it can be supplied with or without an indicator. Made in Germany

Product features:

Material design: Steel
Connection type: Solder ODF
Connection: 1/2"

Product attributes:

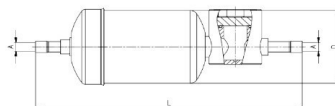
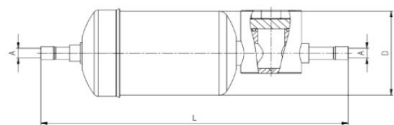

HANSA Artikeliste Multiplex - Kombis Lötschluss

Beschreibung		Maße				Gewicht	P max.
Typ	HANSA Best. Nr.	für Rohr ø	A	D	L +/-3mm	kg	bar
		mm	mm	mm	mm		
Multiplex Kombi Stahl HMK082 sm FI	2837406050	6	6,1	52	172,0	0,47	60
Multiplex Kombi Stahl HMK083 sm FI	2837410050	10	10,1	52	188,0	0,47	60
Multiplex Kombi Stahl HMK084 sm FI	2837412050	12	12,1	52	180,0	0,48	60
Multiplex Kombi Stahl HMK162 sm FI	2838406050	6	6,1	75	182,0	0,71	55
Multiplex Kombi Stahl HMK163 sm FI	2838410050	10	10,1	75	198,0	0,72	55
Multiplex Kombi Stahl HMK164 sm FI	2838412050	12	12,1	75	191,0	0,72	55
Multiplex Kombi Stahl HMK082 sm SG	2837506050	6	6,1	52	172,0	0,47	55
Multiplex Kombi Stahl HMK083 sm SG	2837510050	10	10,1	52	188,0	0,47	60
Multiplex Kombi Stahl HMK084 sm SG	2837512050	12	12,1	52	180,0	0,47	60
Multiplex Kombi Stahl HMK162 sm SG	2838506050	6	6,1	75	182,0	0,71	60
Multiplex Kombi Stahl HMK163 sm SG	2838510050	10	10,1	75	198,0	0,71	55
Multiplex Kombi Stahl HMK164 sm SG	2838512050	12	12,1	75	191,0	0,71	55

Beschreibung	HANSA Best. Nr.	Empfohlen bis Kälteleistung						Wasseraufnahmefähigkeit bei 25°C gemessen nach ARI-Standard 710-86					
		R134a R1234	R454A R507A	R407C	R410A	R449A R452A	R134a R1234	R404A R507A	R407C	R410A	R449A R452A		
		KW	KW	KW	KW	KW	g	g	g	g	g		
Multiplex Kombi Stahl HMK082 sm FI	2837406050	13,00	9,00	14,50	14,50	9,00	12,2	13,9	12,2	12,0	12,1		
Multiplex Kombi Stahl HMK083 sm FI	2837410050	13,00	9,00	14,50	14,50	9,00	12,2	13,9	12,2	12,0	12,1		
Multiplex Kombi Stahl HMK084 sm FI	2837412050	13,00	9,00	14,50	14,50	9,00	12,2	13,9	12,2	12,0	12,1		
Multiplex Kombi Stahl HMK162 sm FI	2838406050	23,00	16,00	25,00	25,00	16,00	19,2	21,9	19,2	19,0	19,2		
Multiplex Kombi Stahl HMK163 sm FI	2838410050	23,00	16,00	25,00	25,00	16,00	19,2	21,9	19,2	19,0	19,2		
Multiplex Kombi Stahl HMK164 sm FI	2838412050	23,00	16,00	25,00	25,00	16,00	19,2	21,9	19,2	19,0	19,2		
Multiplex Kombi Stahl HMK082 sm SG	2837506050	13,00	9,00	14,50	14,50	9,00	12,2	13,9	12,2	12,0	12,1		
Multiplex Kombi Stahl HMK083 sm SG	2837510050	13,00	9,00	14,50	14,50	9,00	12,2	13,9	12,2	12,0	12,1		
Multiplex Kombi Stahl HMK084 sm SG	2837512050	13,00	9,00	14,50	14,50	9,00	12,2	13,9	12,2	12,0	12,1		
Multiplex Kombi Stahl HMK162 sm SG	2838506050	23,00	16,00	25,00	25,00	16,00	19,2	21,9	19,2	19,0	19,2		
Multiplex Kombi Stahl HMK163 sm SG	2838510050	23,00	16,00	25,00	25,00	16,00	19,2	21,9	19,2	19,0	19,2		
Multiplex Kombi Stahl HMK164 sm SG	2838512050	23,00	16,00	25,00	25,00	16,00	19,2	21,9	19,2	19,0	19,2		

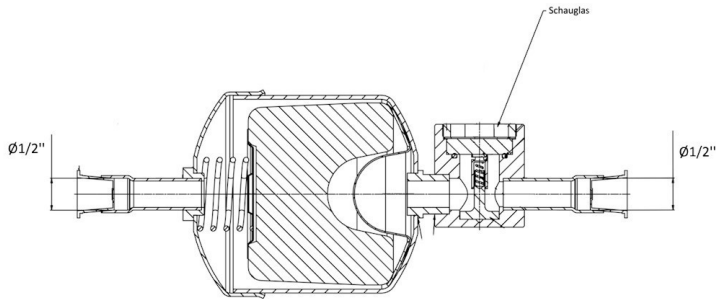

HANSA 2838512050